

4" WIDE SPREAD BATHROOM FAUCET INSTALLATION MANUAL

Tools You Will Need :

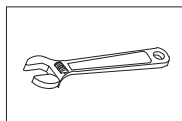

Adjustable wrench

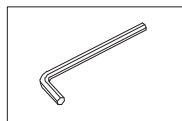

Hexagon wrench

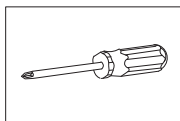

Philips Screwdriver

Notes before installation :

1. Please check that all components are present.
2. Before installation ensure that all feed lines are clear of debris and on/off valve is present.
3. Ensure water pressure is between 20-125 PSI (Includes combination of hot and cold feed lines).
4. Pictures in the manual are general in content and may not represent exactly your purchased faucet. If you are having difficulties please contact a professional plumber.
5. If you will be away from home for an extended period you should shut off the main water supply.

Daily maintenance

1. Use a soft cloth and vinegar to remove hard-water spots.
2. Check aerator (if present) regularly for calcium build up as when water stream is not optimum.
3. DO NOT use caustic cleaning products as the use will break down finish and will void the product warranty.
4. Acceptable cleaners include vinegar or mild non-abrasive liquid detergents.
5. If the water pressure appears to be less than optimum remove, inspect, clean or replace aerator.

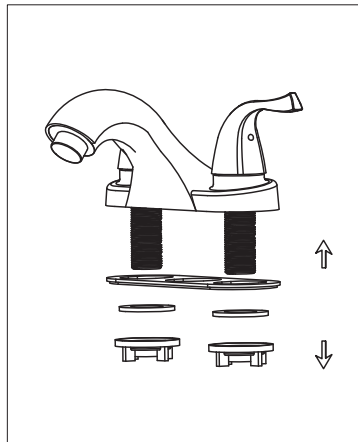

1. Remove the rubber washer , metal washer and locking nut from the faucet.

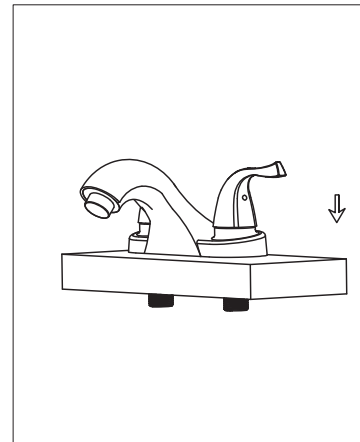

2. Install faucet through center hole .

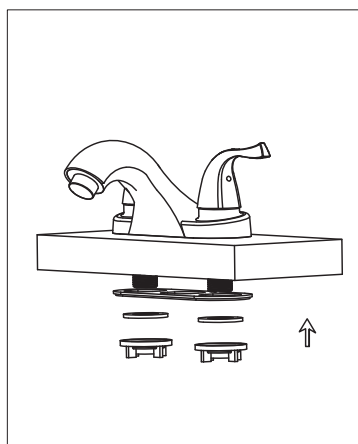

3. Assembly rubber washer, metal washer and lock nut onto faucet, then use the screwdriver to tighten the lock nut.

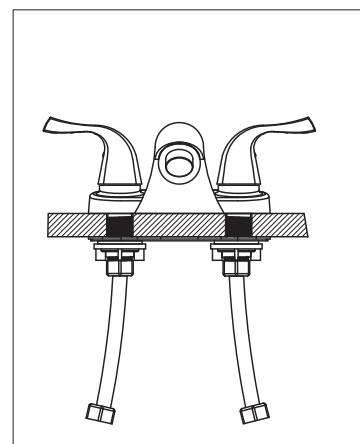

4. Screw and tighten the hot & cold flexible hoses to the faucet.

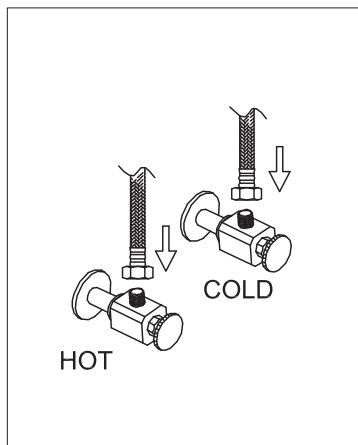

5. Attach flexible hose to water supply.

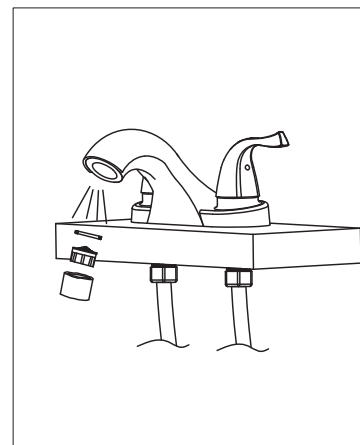

6. Remove the aerator, turn on faucet handle for 1 minute to flush debris from faucet. Close the handles and re-assemble the shower.